



# PFS100

*Strip Nailer*



[www.paslode.org](http://www.paslode.org)



**NEVER STOP BUILDING**

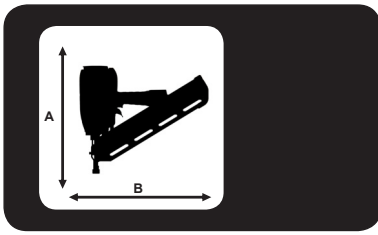

# PFS100

		<p>A = 360 mm B = 500 mm C = 115 mm</p>
		<p>= 3,82 kg</p>

<p>2,8 l (6 bar) /</p>
<p>Ps max. = 8,3 bar</p>

<p>EN 12549+EN ISO 4871</p>	<p>L<sub>WA.1s</sub> = 96 dBA L<sub>pA.1s</sub> = 90 dBA L<sub>pA.1s1m</sub> = 83 dBA</p>
<p>EN12096 : 2017</p> <p>ISO 8662-11</p>	<p>Vibration = 4,4 m/s<sup>2</sup></p>

<p>2x</p>		
<p>PASLODE 34° STRIP NAILS</p>	<p>Max. 77x</p>	<p>d= 2,8 - 3,4mm L= 50 - 100 mm</p>





+



=



EN ISO11148-13  
International  
Safety  
Standard

	<p>Sequential trigger actuation/ Einzelauslösung/ enkelschots/ Déclenchement du tir - mode séquentiel/ Funcionamiento secuencial "en continuo"/ Gatilho de actuação sequencial/ funzionamento sequenziale (colpo a colpo)/ Enkeltskuds aftrækker/ Enkelskott/ Enkeltskudds avtrekker/ Kertalaukaisu/ Üksiklasu meetodil töötamine/ Uruchomienie spustu sekwencyjne/ Sekvenčni spoušt/ Egyes lövés (szakaszosan működtetett elsütő billentyűvel)/ Posamezno proženje/ Kontaktirajte singl</p>
 	<p>Contact trigger actuation/ Kontaktauslösung/ repeterend schieten/ Déclenchement du tir - mode rafale/ Funcionamiento por contacto "clavo a clavo"/ Gatilho de actuação por contacto/ funcionamiento a contacto/ Stødskydnings aftrækker/ Støtskjutning/ Støtspikrings avtrekker/ Kosketuslaukaisu/ Automaatmeetodil töötamine/ Uruchomienie spustu przez kontakt/ Kontaktní spoušt/ Sorozatlövés (folyamatosan behúzott elsütő billentyűvel)/ Kontaktno proženje/ Kontaktirajte pokretanje</p>

**Model: PFS100**  
**No. 650444**



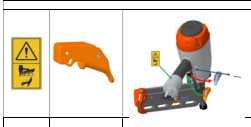

			
<p><b>No 014748 + No. 577430</b></p>			<p><b>No 577428</b></p>

**Accessories**

	
<p><b>No. 151299</b></p>	<p><b>No. 613172</b></p>
<p><b>0,5 l oil</b></p>	

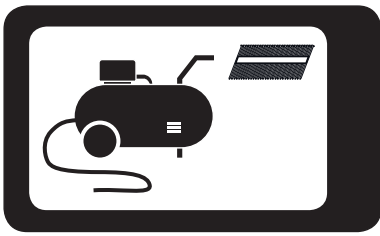

014748

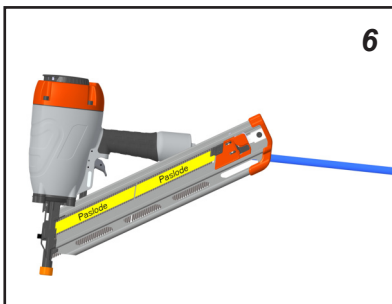
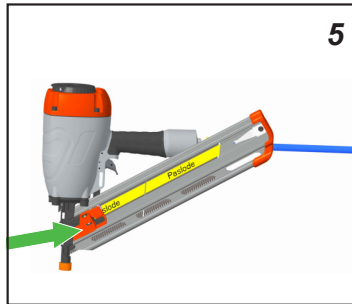
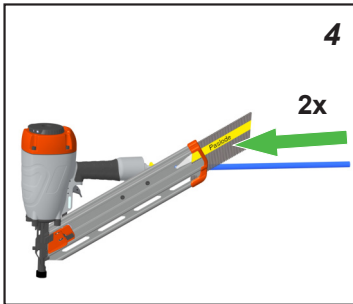
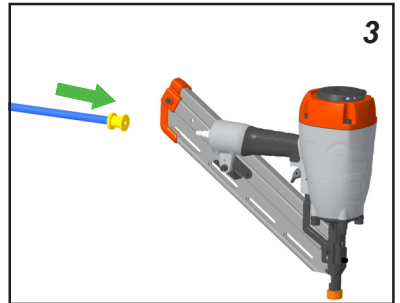
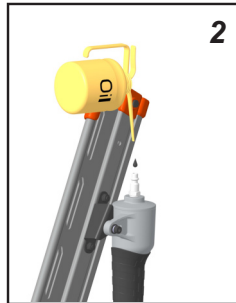
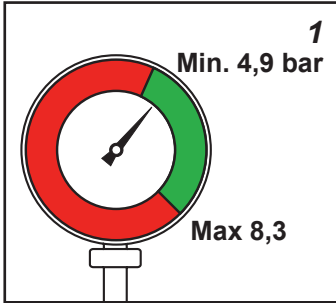

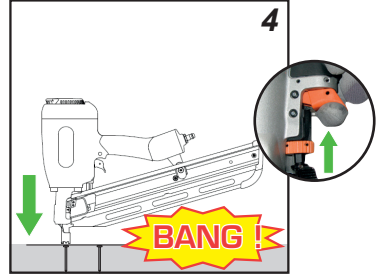
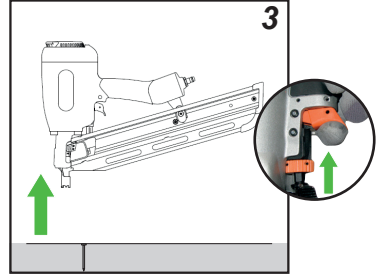
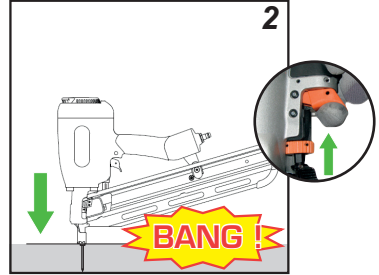
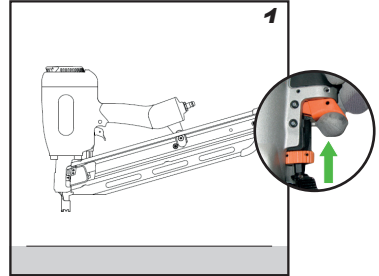
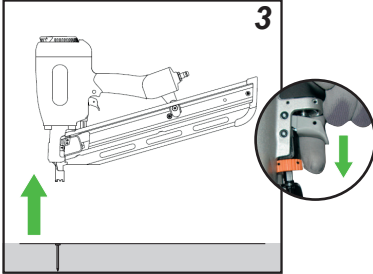
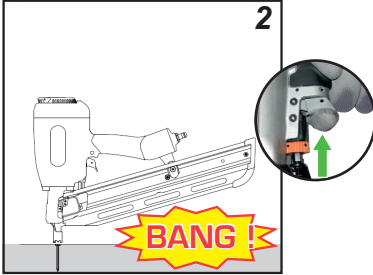
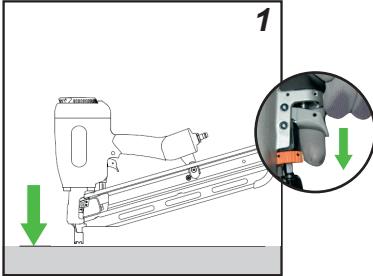
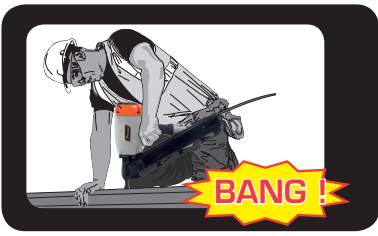

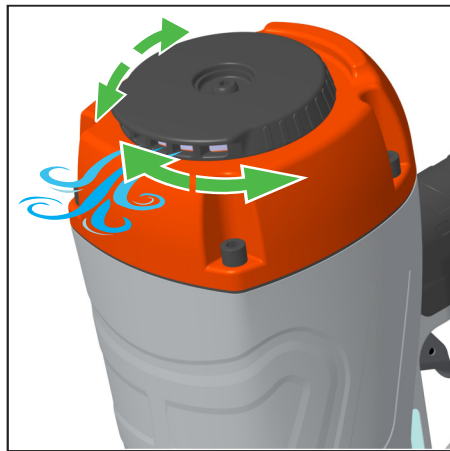
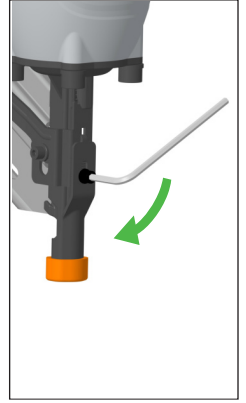
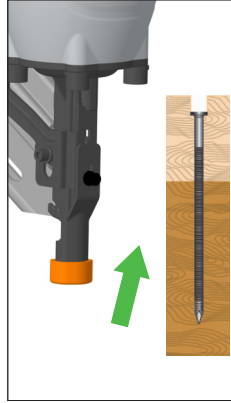
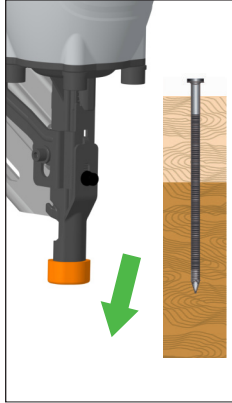
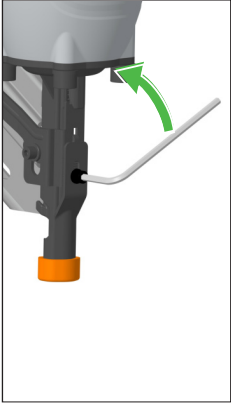
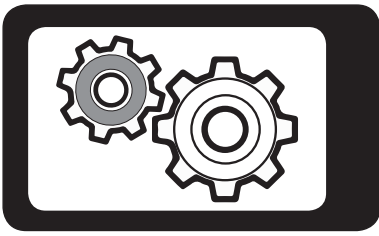

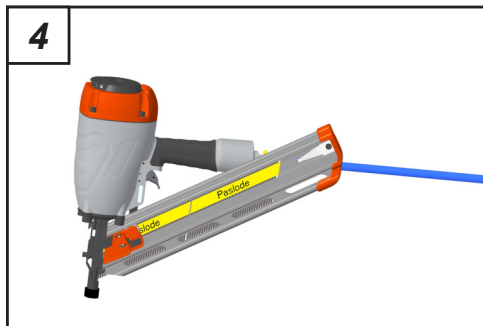
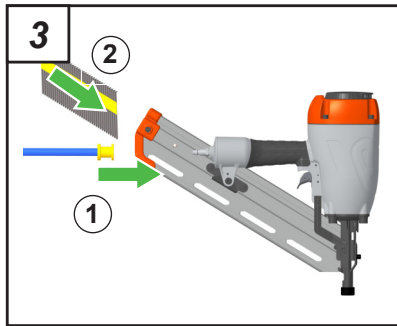
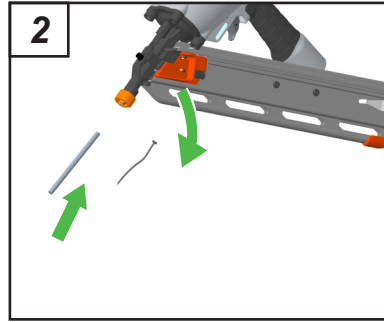
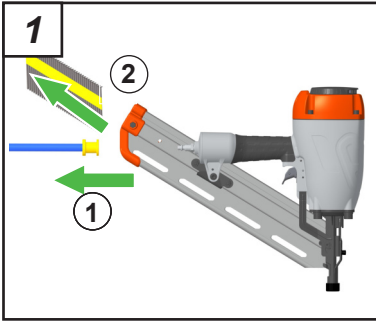
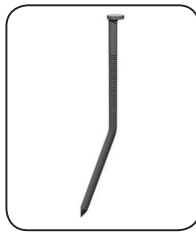

YY= Year of manufacture  
WW = Week of manufacture



## Resting position





ITW Befestigungssysteme GmbH  
Carl-Zeiss-Str. 19  
30966 Hemmingen, Germany

ITWCP UK Glenrothes  
Fife UK KY6 2SW

CODE: 577430 (12/2024)